

HYDE PARK BRANCH OF THE FRED DOW DRAIN

MUSKEGON COUNTY DRAIN COMMISSIONER: JEFFREY A. HEPLER

PLAN INDEX

FILE NO.	DESCRIPTION	NO.
JDR-1875-01	COVER SHEET	1
JDR-1875-02	PLAN AND PROFILE STA. 0+00 P.O.B. TO STA. 8+00	2
JDR-1875-03	PLAN & PROFILE STA. 0+00 TO STA. 14+00 P.O.E.	3
JDR-1875-04	STANDARD DETAILS	4

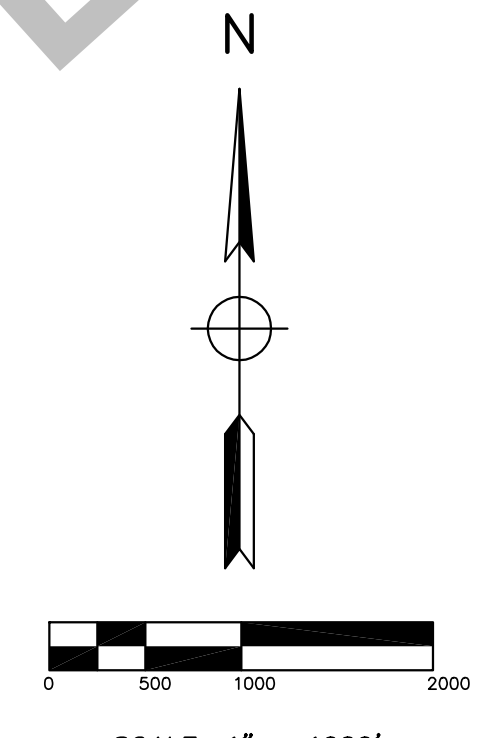
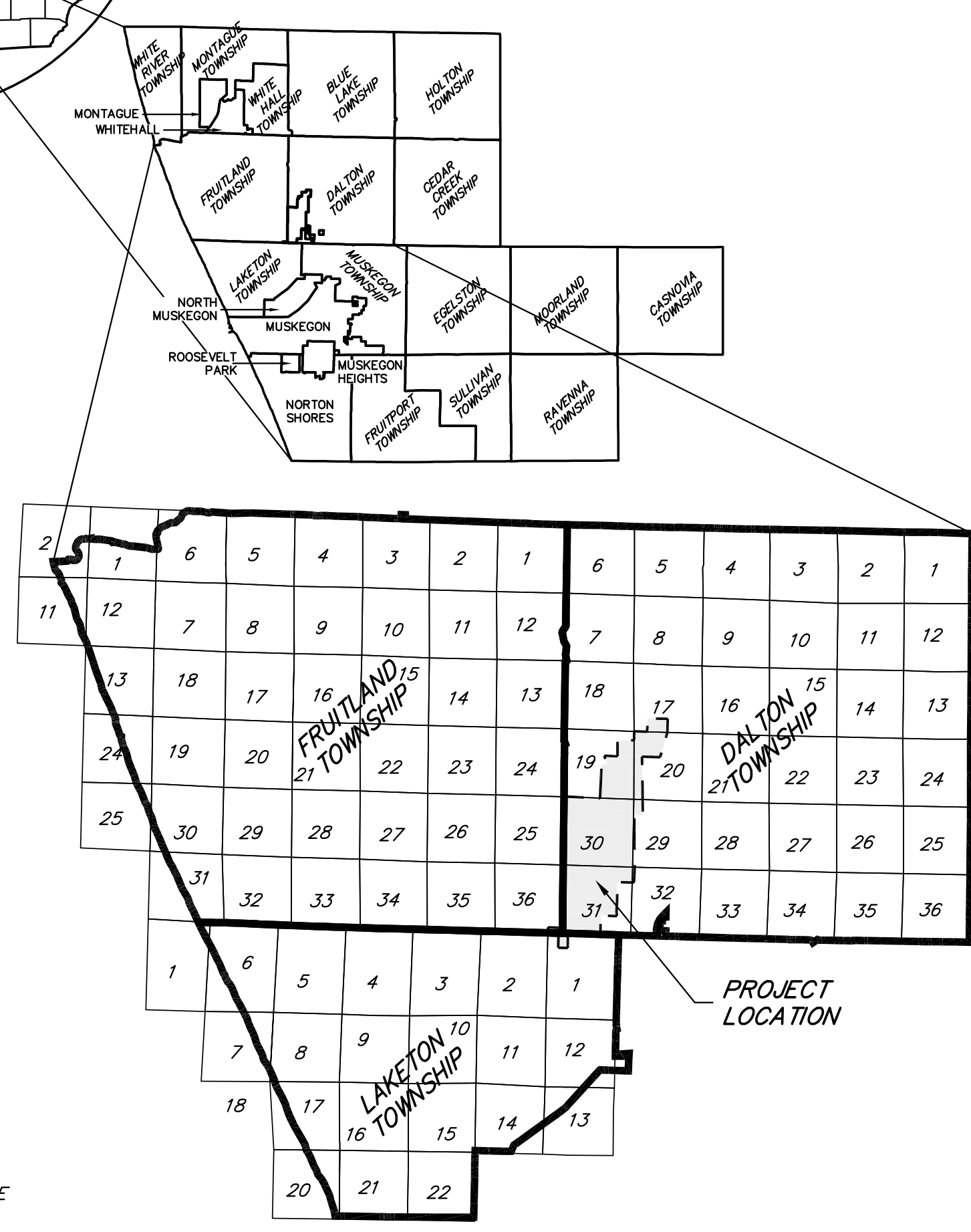
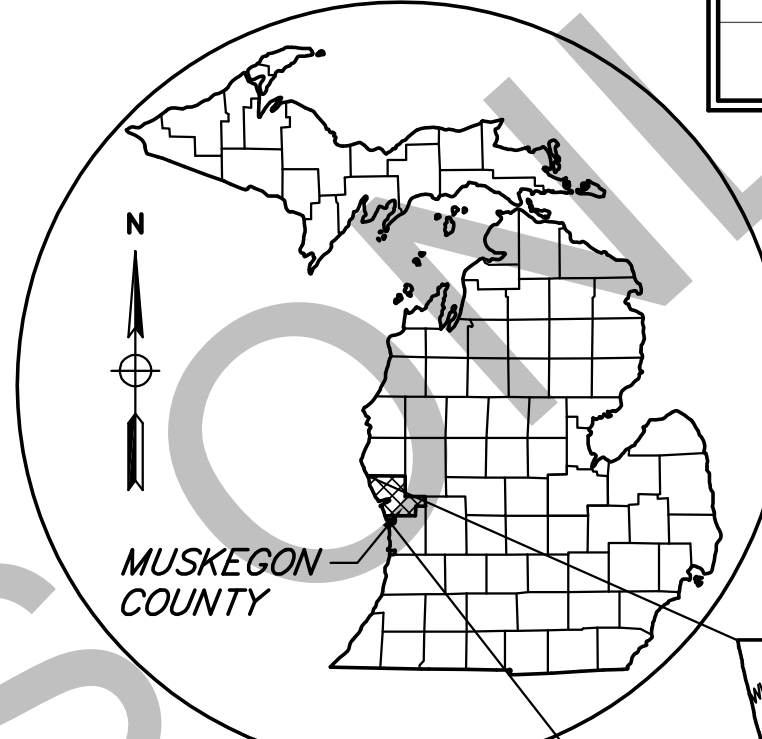
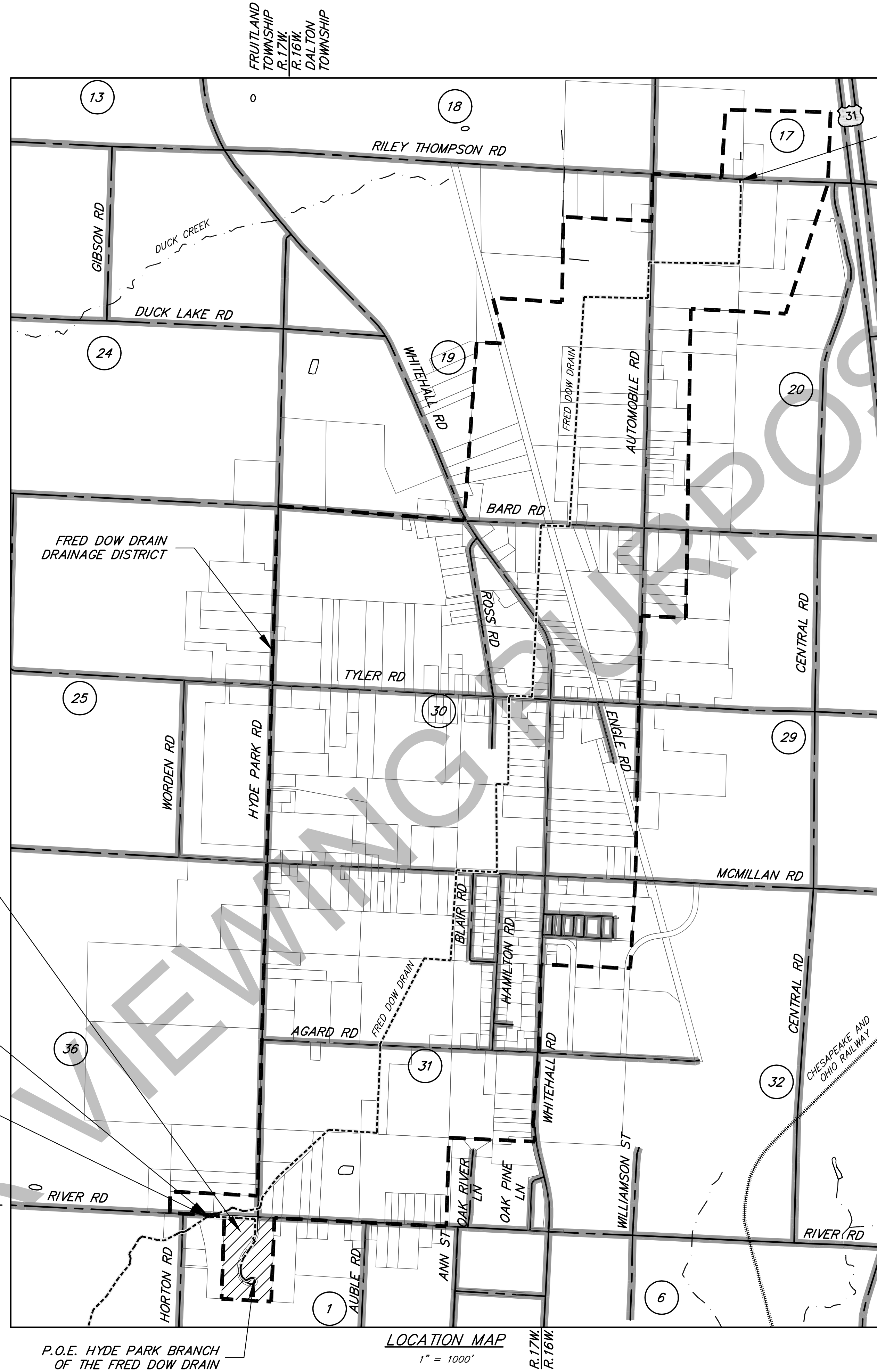

SCALE: 1" = 1000'
 T.11N. - R.16W.
 DALTON TOWNSHIP &
 T.11N. - R.17W.
 FRUITLAND TOWNSHIP &
 T.10N. - R.17W.
 LAKETON TOWNSHIP
 MUSKEGON COUNTY, MICHIGAN

LEGEND

- PROPOSED DISTRICT LINE
- ROAD
- - - PROJECT DRAIN
- - - OTHER WATERCOURSES

P:\proj\2009\1179445G2009_FredDowDrain.dwg, 1/25/2010 2:41:53 PM, mcoomackta

TAM	BID SET	01/27/10
POC	ASO UTILITY REVIEW	11/06/09
BY	MARK	REVISIONS
		DATE

THE WORK REPRESENTED BY THIS DRAWING WAS DESIGNED BY THE ENGINEER FOR THIS SPECIFIC APPLICATION AND SPECIFIC LOCATION DESCRIBED HEREON IN ACCORDANCE WITH THE CONDITIONS PREVALENT AT THE TIME THE DESIGN WAS DONE. THE ENGINEER DOES NOT GUARANTEE AND WILL NOT BE LIABLE FOR ANY OTHER LOCATION, CONDITION, DESIGN OR PURPOSE.

FRED DOW DRAIN
 HYDE PARK BRANCH
 MUSKEGON CO., MICHIGAN

COVER SHEET

OFFICE LOCATIONS		ST. JOHNS OFFICE	
SAGINAW, MI	ST. JOHNS, MI	1400 Zeeb Drive	St. Johns, MI 49879
CARO, MI	BELLEVILLE, MI	Tel. 989-224-2355	Fax. 989-224-2357
		www.SpicerGroup.com	
DE. BY: TAM	CH. BY: PLF	PROJECT NO. 1179445G2009	
DR. BY: TAM	APP. BY: LJP		
STDS.	SHEET 1 OF 4		
DATE AUGUST, 2009	FILE NO. JDR-1875-01		
SCALE 1"=1000'			

PROJECT DATUM

HORIZONTAL:	STATE PLANE SOUTH MI '83 2113
VERTICAL:	NORTH AMERICAN VERTICAL DATUM '88
GIS DATA SOURCE:	MUSKEGON CO. GIS; PARCELS - 2009 EQUALIZATION DATABASE; AERIAL IMAGERY; DRAINAGE DISTRICT BOUNDARY; ROAD ROW; DRAINAGE EASEMENT BOUNDARY

DALTON TOWNSHIP T.11N.
 T.10N. MUSKEGON TOWNSHIP